

DESIGN **RENZO SERAFINI**

Imbuto
chandellier



IP20



DESCRIZIONE DESCRIPTION

**corpo in ferro, 8
cappelli in alluminio
orientabili, acidatura
scura con interno oro
aranciato**

iron, 8 adjustable
aluminium hats,
external dark etching
finish, internal
burnished finish

LAMPADA/ATTACCO
LAMP/LAMP HOLDER

GU10 230V

***lampadina non inclusa**

***bulb not included**

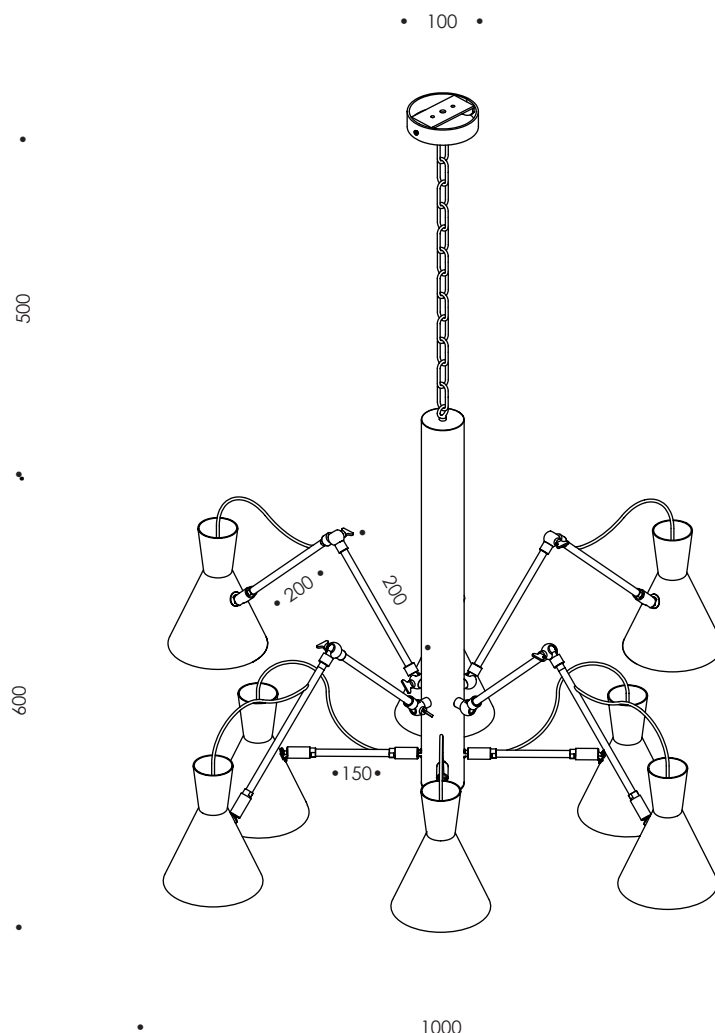

COD. ART.10.027

FINITURA acidatura scura / dark etched

MATERIALE ferro, alluminio / iron, aluminum

Renzo Serafini

DESIGN RENZO SERAFINI

Imbuto chandellier

ISTRUZIONI DI MONTAGGIO

ASSEMBLY INSTRUCTION

[disattivare l'alimentazione di rete prima di iniziare l'installazione]

[switch off the mains supply before starting the installation]

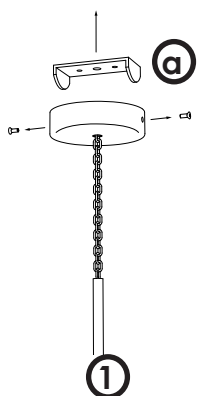

svitare le viti e fissare a soffitto la staffa 'a'
undo the screws and fix 'a' to the ceiling

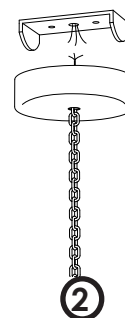

eseguire il cablaggio con alimentazione 230V.
Collegare cavo giallo/verde di messa a terra.

do the wiring with 230V power supply.
Connect the yellow/green ground wire

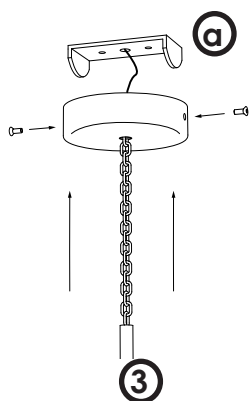

fissare la struttura ad 'a' ed avvitare le viti laterali
fix the structure to 'a' and tighten the side screws

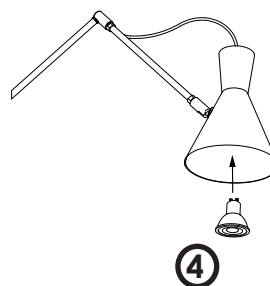

inserire le lampadine ai portalamпада GU10
insert the bulbs to the GU10 lampholders

Renzo Serafini