

*Renzo Serafini*

DESIGN **RENZO SERAFINI**

# LUCE FUORI

10.046

CE  IP20

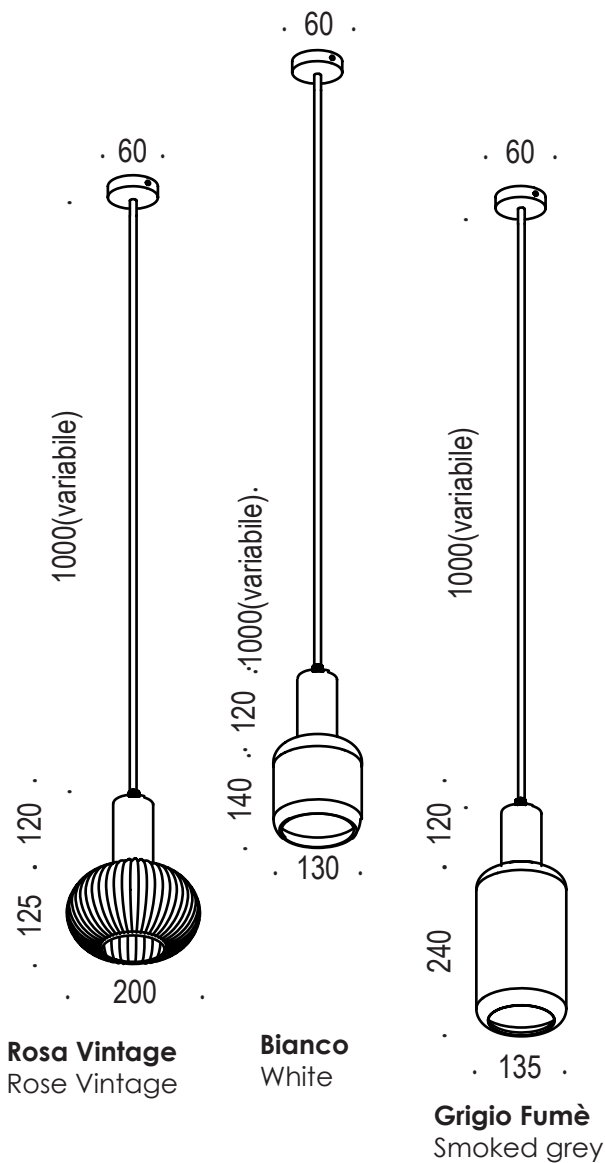

**Lampada a sospensione con cilindro in alluminio nero, LED interno incluso, cavo in tessuto nero, basetta tonda, 3 modelli di vetro: vintage rosa lucido, vaso basso bianco opaco, vaso alto grigio fumè, attacco GU10 230V**

Pendant lamp with black aluminum cylinder, internal LED included, black fabric cable, small round base, 3 glass models: glossy pink vintage, matt white low vase, smoky gray tall vase, lampholder GU10 230V

**attacco** • lampholder  
GU10 DIM.

**tensione di alimentazione** • supply voltage  
230V

**potenza** • power  
7W

**lumen** • lumen  
510 Lm

**temperatura colore** • colour temperature  
2700K

**classe energetica** • energy label  
F

**materiale** • material  
alluminio/aluminum

**finitura** • finish  
nero/black

**materiale diffusore** • diffuser material  
vetro/glass

**finitura diffusore** • diffuser finish  
rosa vintage, bianco, grigio fumè/rose vintage, white, smoked grey

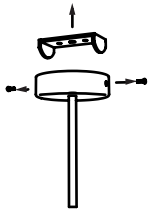

1. **svitare le viti e fissare a soffitto la staffa**  
undo the screws and fix the bracket to the ceiling

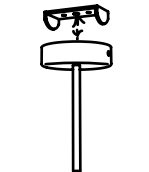

2. **eseguire il cablaggio con alimentazione 230V.**  
**Collegare cavo giallo/verde di messa a terra**  
do the wiring with 230V power supply.  
Connect the yellow/green ground wire

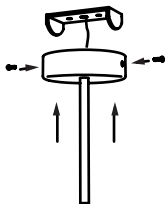

3. **fissare la struttura alla staffa**  
fix the structure to the bracket